

Ball valves / Vacuum technique, Chemical technique

Art.No EUR Art.No EUR

Ball valve ES, DIN, female thread

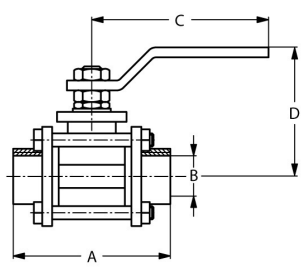

DN	A	B	C	D			AISI316-PTFE	
8	65	R 1/4"	96	60			511329	45,60
10	65	R 3/8"	96	60			511330	45,60
15	71	R 1/2"	125	63			511331	57,40
20	85	R 3/4"	125	67			511332	74,70
25	95	R 1"	145	83			511333	98,80
32	112	R 1,25"	145	86			511334	117,20
40	123	R 1,5"	200	105			511335	162,60
50	141	R 2"	200	114			511336	226,90
65	185	R 2,5"	370	143			511337	464,60
80	192	R 3"	370	159			511338	669,70
100	226	R 4"	370	178			511339	1.126,10

Hand lever stainless steel with PVC coat Gaskets not FDA-conform

Ball valve ESA

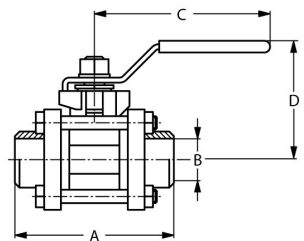

DN	A	B (Ø Ball)	C	D			AISI316-PTFE	
10	60	10	120	46			511030	96,10
15	75	15	145	66			511031	123,90
20	80	19	145	68			511032	138,50
25	90	25	185	85			511033	177,60
32	110	30	185	91			511034	231,70
40	120	38	280	106			511035	335,80
50	140	51	280	116			511036	451,20
65	185	64	370	140			511037	805,50
80	205	76	370	148			511038	1.106,30
100	240	101	470	174			511039	1.738,40

Hand lever steel zinc coated